

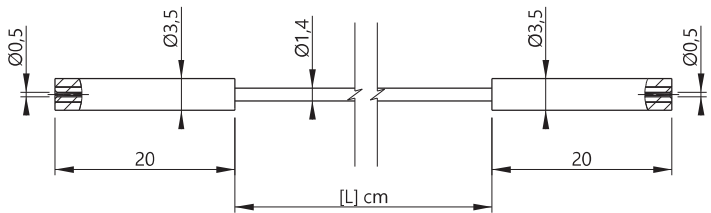

MICRO TEST • MICRO MESURE • MICRO TEST
 Micro leads • Mini cordons • Micro Leitungen

TYPE 209050-F-F

Ø0,5MM JACKS TEST LEAD
CORDON FICHES Ø0,5MM FEMELLE-FEMELLE
 MESSLEITUNG Ø0,5MM BUCHSE BEIDSEITIG



Reference
Référence
 Bestell-Nr **209050-F-F-[L]-#**

Wire
Câble
 Litze SIL 0,22mm²

Lengths Longueurs Längen [cm]	Rated voltage Tension assignée Bemessungsspannung	Rated current Intensité assignée Bemessungsstrom	Contact parts Contacts Kontaktteile	Insulation Isolant Isolierteile	Colours [#] Couleurs [#] Farben [#]												
10 20	≤30VAC ≤60VDC	2A	AuNi coated brass Laiton doré Messing vergoldet	Rubber Caoutchouc Gummi	<table border="1"> <tr> <td>R</td> <td>N</td> <td>BL</td> <td>V</td> <td>J</td> <td>BC</td> </tr> <tr> <td>2</td> <td>0</td> <td>6</td> <td>5</td> <td>4</td> <td>9</td> </tr> </table>	R	N	BL	V	J	BC	2	0	6	5	4	9
R	N	BL	V	J	BC												
2	0	6	5	4	9												

x10

TYPE 209050-M-F

Ø0,5MM CONNECTORS TEST LEAD, JACK / PLUG
CORDON FICHES Ø0,5MM, FEMELLE / MÂLE
 MESSLEITUNG Ø0,5MM BUCHSE / STECKER

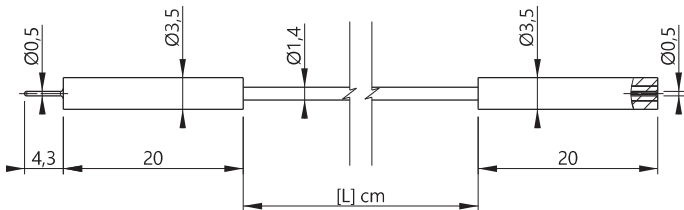

Reference
Référence
 Bestell-Nr **209050-M-F-[L]-#**

Wire
Câble
 Litze SIL 0,22mm²

Lengths Longueurs Längen [cm]	Rated voltage Tension assignée Bemessungsspannung	Rated current Intensité assignée Bemessungsstrom	Contact parts Contacts Kontaktteile	Insulation Isolant Isolierteile	Colours [#] Couleurs [#] Farben [#]												
10 20	≤30VAC ≤60VDC	2A	AuNi coated brass Laiton doré Messing vergoldet	Rubber Caoutchouc Gummi	<table border="1"> <tr> <td>R</td> <td>N</td> <td>BL</td> <td>V</td> <td>J</td> <td>BC</td> </tr> <tr> <td>2</td> <td>0</td> <td>6</td> <td>5</td> <td>4</td> <td>9</td> </tr> </table>	R	N	BL	V	J	BC	2	0	6	5	4	9
R	N	BL	V	J	BC												
2	0	6	5	4	9												

x10



TYPE 209050-M-M

Ø0,5MM PLUGS TEST LEAD
CORDON FICHES Ø0,5MM MÂLE-MÂLE
MESSLEITUNG Ø0,5MM STECKER BEIDSEITIG

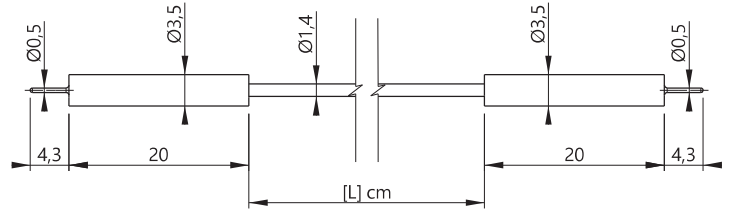

Reference Référence Bestell-Nr	209050-M-M-[L]-#		Wire Câble Litze	SIL 0,22mm ²						
Lengths Longueurs Längen [cm]	Rated voltage Tension assignée Bemessungsspannung	Rated current Intensité assignée Bemessungsstrom	Contact parts Contacts Kontaktteile	Insulation Isolant Isolierteile	Colours [#] Couleurs [#] Farben [#]					
10 20	≤30VAC ≤60VDC	2A	AuNi coated brass Laiton doré Messing vergoldet	Rubber Caoutchouc Gummi	R	N	BL	V	J	BC
					2	0	6	5	4	9

x10

TYPE 209078-F-F

Ø0,8MM JACKS TEST LEAD
CORDON FICHES Ø0,8MM FEMELLE-FEMELLE
MESSLEITUNG Ø0,8MM BUCHSE BEIDSEITIG

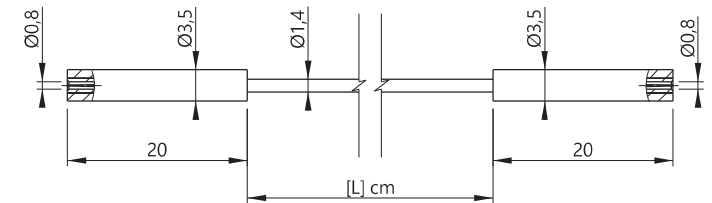

Reference Référence Bestell-Nr	209078-F-F-[L]-#		Wire Câble Litze	SIL 0,22mm ²						
Lengths Longueurs Längen [cm]	Rated voltage Tension assignée Bemessungsspannung	Rated current Intensité assignée Bemessungsstrom	Contact parts Contacts Kontaktteile	Insulation Isolant Isolierteile	Colours [#] Couleurs [#] Farben [#]					
10 20	≤30VAC ≤60VDC	2A	AuNi coated brass Laiton doré Messing vergoldet	Rubber Caoutchouc Gummi	R	N	BL	V	J	BC
					2	0	6	5	4	9

x10



MICRO TEST • MICRO MESURE • MICRO TEST
 Micro leads • Mini cordons • Micro Leitungen

TYPE 209078-M-F

Ø0,8MM CONNECTORS TEST LEAD, JACK / PLUG
 CORDON FICHES Ø0,8MM, FEMELLE / MÂLE
 MESSLEITUNG Ø0,8MM BUCHSE / STECKER

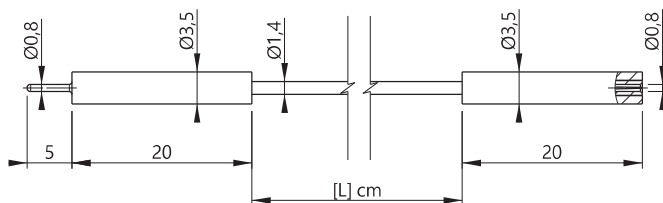

Reference
 Référence
 Bestell-Nr **209078-M-F-[L]-#**

Wire
 Câble
 Litze SIL 0,22mm²

Lengths Longueurs Längen [cm]	Rated voltage Tension assignée Bemessungsspannung	Rated current Intensité assignée Bemessungsstrom	Contact parts Contacts Kontaktteile	Insulation Isolant Isolierteile	Colours [#] Couleurs [#] Farben [#]												
10 20	≤30VAC ≤60VDC	2A	AuNi coated brass Laiton doré Messing vergoldet	Rubber Caoutchouc Gummi	<table border="1"> <tr> <td>R</td> <td>N</td> <td>BL</td> <td>V</td> <td>J</td> <td>BC</td> </tr> <tr> <td>2</td> <td>0</td> <td>6</td> <td>5</td> <td>4</td> <td>9</td> </tr> </table>	R	N	BL	V	J	BC	2	0	6	5	4	9
R	N	BL	V	J	BC												
2	0	6	5	4	9												

x10

TYPE 209078-M-M

Ø0,8MM PLUGS TEST LEAD
 CORDON FICHES Ø0,8MM MÂLE-MÂLE
 MESSLEITUNG Ø0,8MM STECKER BEIDSEITIG

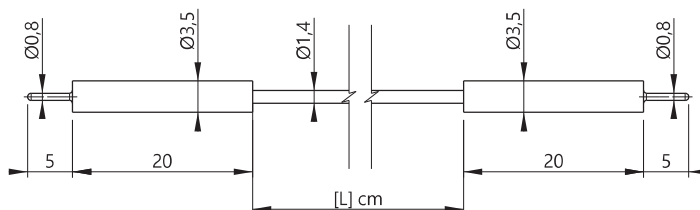

Reference
 Référence
 Bestell-Nr **209078-M-M-[L]-#**

Wire
 Câble
 Litze SIL 0,22mm²

Lengths Longueurs Längen [cm]	Rated voltage Tension assignée Bemessungsspannung	Rated current Intensité assignée Bemessungsstrom	Contact parts Contacts Kontaktteile	Insulation Isolant Isolierteile	Colours [#] Couleurs [#] Farben [#]												
10 20	≤30VAC ≤60VDC	2A	AuNi coated brass Laiton doré Messing vergoldet	Rubber Caoutchouc Gummi	<table border="1"> <tr> <td>R</td> <td>N</td> <td>BL</td> <td>V</td> <td>J</td> <td>BC</td> </tr> <tr> <td>2</td> <td>0</td> <td>6</td> <td>5</td> <td>4</td> <td>9</td> </tr> </table>	R	N	BL	V	J	BC	2	0	6	5	4	9
R	N	BL	V	J	BC												
2	0	6	5	4	9												

x10



TYPE 209100

Ø1MM STACKABLE PLUGS TEST LEAD
CORDON FICHES Ø1MM MÂLES EMPILABLES
MESSLEITUNG Ø1MM STAPELBARER STECKER BEIDSEITIG

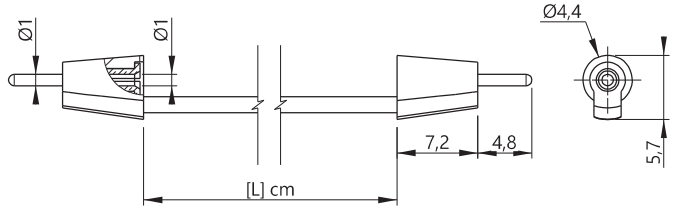

Reference
Référence
Bestell-Nr

209100-AR-[L]-#

Wire
Câble
Litze

SIL 0,22mm²

Lengths Longueurs Längen [cm]	Rated voltage Tension assignée Bemessungsspannung	Rated current Intensité assignée Bemessungsstrom	Contact parts Contacts Kontaktteile	Insulation Isolant Isolierteile	Colours [#] Couleurs [#] Farben [#]												
10 20 30 40 50	≤30VAC ≤60VDC	2A	AuNi coated brass Laiton doré Messing vergoldet	Rubber Caoutchouc Gummi	<table border="1"> <tr> <td>R</td> <td>N</td> <td>BL</td> <td>V</td> <td>J</td> <td>BC</td> </tr> <tr> <td>2</td> <td>0</td> <td>6</td> <td>5</td> <td>4</td> <td>9</td> </tr> </table>	R	N	BL	V	J	BC	2	0	6	5	4	9
R	N	BL	V	J	BC												
2	0	6	5	4	9												

x10

TYPE 2060/M0.5

TEST LEAD, Ø4MM JACK / Ø0,5MM PLUG
CORDON FICHES, FEMELLE Ø4MM / MÂLE Ø0,5MM
MESSLEITUNG Ø4MM BUCHSE / Ø0,5MM STECKER

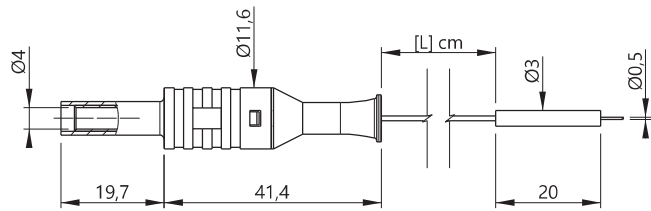

Reference
Référence
Bestell-Nr

2060/M0.5MM-10-#

Wire
Câble
Litze

SIL 0,22mm²

Lengths Longueurs Längen [cm]	Rated voltage Tension assignée Bemessungsspannung	Rated current Intensité assignée Bemessungsstrom	Contact parts Contacts Kontaktteile	Insulation Isolant Isolierteile	Colours [#] Couleurs [#] Farben [#]												
10	≤30VAC ≤60VDC	1A	AuNi coated brass Laiton doré Messing vergoldet	PP & Rubber PP & Caoutchouc PP & Gummi	<table border="1"> <tr> <td>R</td> <td>N</td> <td>BL</td> <td>V</td> <td>J</td> <td>BC</td> </tr> <tr> <td>2</td> <td>0</td> <td>6</td> <td>5</td> <td>4</td> <td>9</td> </tr> </table>	R	N	BL	V	J	BC	2	0	6	5	4	9
R	N	BL	V	J	BC												
2	0	6	5	4	9												

x10



MICRO TEST • MICRO MESURE • MICRO TEST
 Micro leads • Mini cordons • Micro Leitungen

TYPE **6822**

JACKS TEST LEAD, Ø2MM / Ø0,8MM
CORDON FICHES FEMELLES, Ø2MM / Ø0,8MM
MESSLEITUNG BUCHSE BEIDSEITIG, Ø2MM / Ø0,8MM

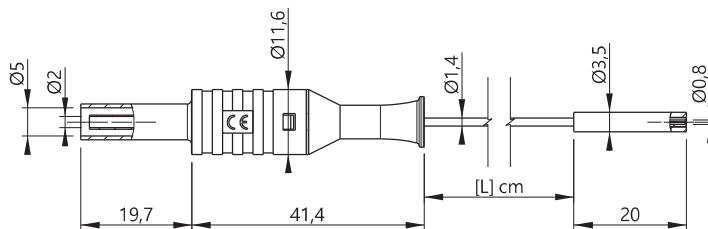

Reference
Référence
 Bestell-Nr **6822-10-#**

Wire
Câble
 Litze SIL 0,22mm²

Lengths Longueurs Längen [cm]	Rated voltage Tension assignée Bemessungsspannung	Rated current Intensité assignée Bemessungsstrom	Contact parts Contacts Kontaktteile	Insulation Isolant Isolierteile	Colours [#] Couleurs [#] Farben [#]												
10	≤30VAC ≤60VDC	2A	AuNi coated brass Laiton doré Messing vergoldet	PP & Rubber PP & Caoutchouc PP & Gummi	<table border="0"> <tr> <td>R</td><td>N</td><td>BL</td><td>V</td><td>J</td><td>BC</td> </tr> <tr> <td>2</td><td>0</td><td>6</td><td>5</td><td>4</td><td>9</td> </tr> </table>	R	N	BL	V	J	BC	2	0	6	5	4	9
R	N	BL	V	J	BC												
2	0	6	5	4	9												

x10

TYPE **6824**

JACKS TEST LEAD, Ø4MM / Ø0,8MM
CORDON FICHES FEMELLES, Ø4MM / Ø0,8MM
MESSLEITUNG BUCHSE BEIDSEITIG, Ø4MM / Ø0,8MM

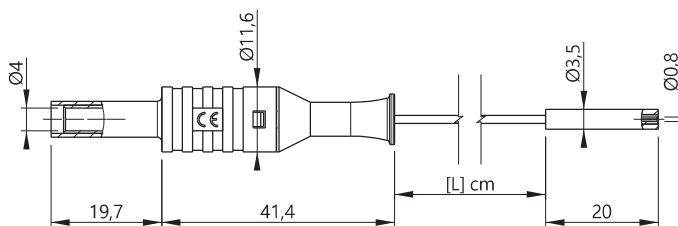

Reference
Référence
 Bestell-Nr **6824-10-#**

Wire
Câble
 Litze SIL 0,22mm²

Lengths Longueurs Längen [cm]	Rated voltage Tension assignée Bemessungsspannung	Rated current Intensité assignée Bemessungsstrom	Contact parts Contacts Kontaktteile	Insulation Isolant Isolierteile	Colours [#] Couleurs [#] Farben [#]												
10	≤30VAC ≤60VDC	2A	AuNi coated brass Laiton doré Messing vergoldet	PP & Rubber PP & Caoutchouc PP & Gummi	<table border="0"> <tr> <td>R</td><td>N</td><td>BL</td><td>V</td><td>J</td><td>BC</td> </tr> <tr> <td>2</td><td>0</td><td>6</td><td>5</td><td>4</td><td>9</td> </tr> </table>	R	N	BL	V	J	BC	2	0	6	5	4	9
R	N	BL	V	J	BC												
2	0	6	5	4	9												

x10



TYPE **ADA2410/F0.8**

Ø4MM BANANA PLUG / 3 X Ø0,8MM SOCKETS ADAPTER
 ADAPTATEUR FICHE BANANE MÂLE Ø4MM / 3 X Ø0,8MM FEMELLE
 ADAPTER Ø4MM BANANENSTECKER / 3 X Ø0,8MM BUCHSEN

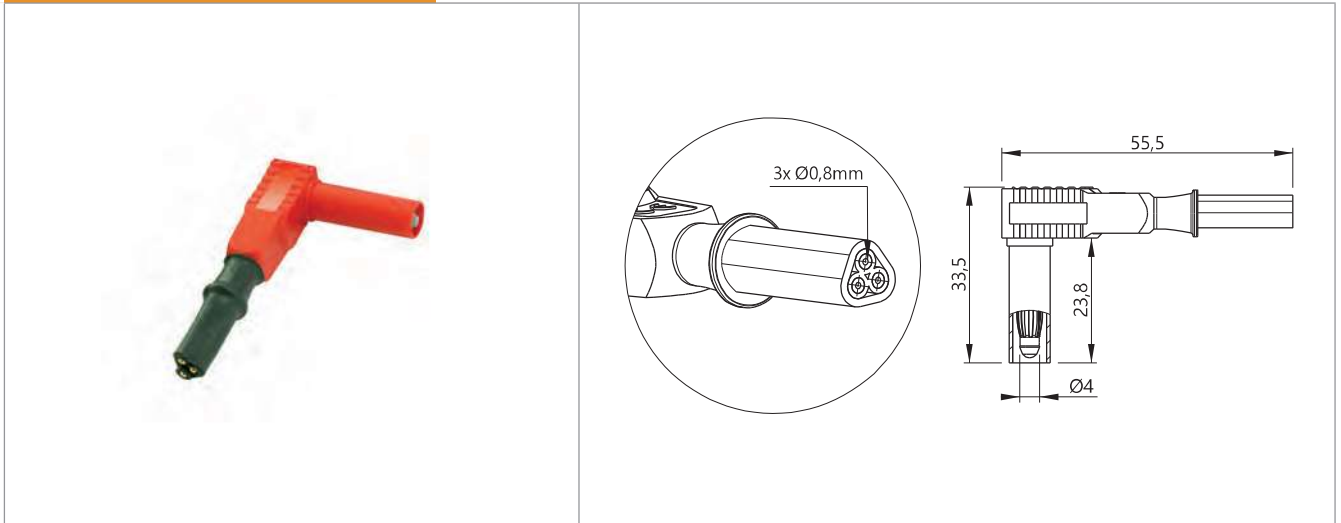

Reference
 Référence
 Bestell-Nr **ADA2410/F0.8MMX3-#**

Rated voltage Tension assignée Bemessungsspannung	Rated current Intensité assignée Bemessungsstrom	Contact parts Contacts Kontaktteile	Insulation Isolant Isolierteile	Colours [#] Couleurs [#] Farben [#]												
≤30VAC ≤60VDC	2A	Ni coated brass Laiton nickelé Messing vernickelt	PP	<table border="1"> <tr> <td>R</td> <td>N</td> <td>BL</td> <td>V</td> <td>J</td> <td>BC</td> </tr> <tr> <td>2</td> <td>0</td> <td>6</td> <td>5</td> <td>4</td> <td>9</td> </tr> </table>	R	N	BL	V	J	BC	2	0	6	5	4	9
R	N	BL	V	J	BC											
2	0	6	5	4	9											

x10



MICRO TEST • MICRO MESURE • MICRO TEST

Mini clips for SMD tests • Mini pinces de test CMS • SMD Miniatur-Klemmprüfspitzen

TYPE 6800

SMD TEST CLIP / Ø0,8MM MALE CONNEXION
PINCE DE TEST CMS / RACCORD MÂLE Ø0,8MM
 SMD KLEMMPRÜFSPITZE / Ø0,8MM STECKERANSCHLUSS

KIT 6800-6 ; -8 ; -12 p.191

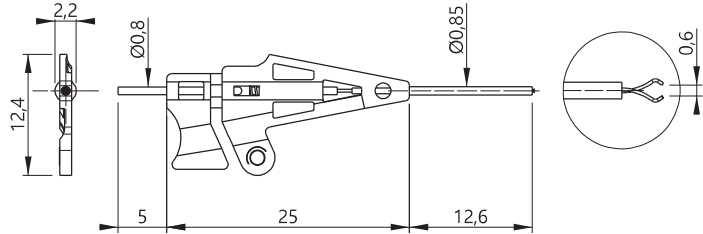

Reference
Référence
 Bestell-Nr **6800-#**

Rated voltage Tension assignée Bemessungsspannung	Rated current Intensité assignée Bemessungsstrom	Contact parts Contacts Kontaktteile	Insulation Isolant Isolierteile	Colours [#] Couleurs [#] Farben [#]												
≤30VAC ≤60VDC	500 mA	AuNi coated brass Laiton doré Messing vergoldet	PA6.6	<table border="0"> <tr> <td>R</td><td>N</td><td>BL</td><td>V</td><td>J</td><td>BC</td> </tr> <tr> <td>2</td><td>0</td><td>6</td><td>5</td><td>4</td><td>9</td> </tr> </table>	R	N	BL	V	J	BC	2	0	6	5	4	9
R	N	BL	V	J	BC											
2	0	6	5	4	9											

This mini CHALLENGER - CLIP is one of the most precise and smallest product on the market. Its size allows testing on the closest SMD connexions (DIP... and so on). Careful positioning permits simultaneous testing in line point by point

Cette mini pince CHALLENGER - CLIP est un des produits les plus petits et plus précis du marché. Ses dimensions autorisent des tests sur les boîtiers CMS (DIP ...) les plus serrés. Un positionnement judicieux permet des contrôles simultanés en ligne point par point

Der Challenger-Clip mit seinen Mini-Klemmen ist einer der kleinsten und genauesten Klemmprüfspitzen. Seine Dimensionen erlauben Messungen an SMD-Gehäusen mit engsten Kontaktabständen. Durch die besondere Positionierung sind auch gleichzeitig Reihenkontrollen (Punkt nach Punkt) möglich

x10

TYPE 6810

SUPPORT RAIL FOR SMD TEST CLIPS
RAILS DE MAINTIEN POUR PINCES DE TEST CMS
 KLEMMPRÜFSPITZEN HALTESCHIENEN

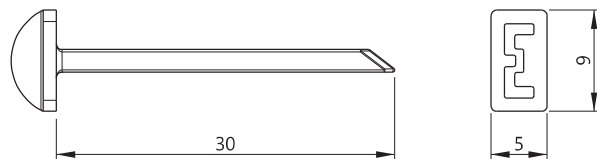

Reference
Référence
 Bestell-Nr **6810**

Insulation Isolant Isolierteile	Colours [#] Couleurs [#] Farben [#]		
PA6.6	<table border="0"> <tr> <td>N</td> </tr> <tr> <td>0</td> </tr> </table>	N	0
N			
0			

The use of support rails when positioning results in a firm hold and allows particularly good contact connexions

L'utilisation de rails de maintien permet un bon maintien et de bons contacts

Die Benutzung von Halteschienen gibt beim Positionieren einen festen Halt und erlaubt besonders gute Kontaktakte



MICRO TEST • MICRO MESURE • MICRO TEST

Mini clips for SMD tests • Mini pincettes de test CMS • SMD Miniatur-Klemmprüfspitzen

TYPE 6606-080

FLEXIBLE SMD TEST CLIP / Ø0,8MM MALE CONNEXION
PINCE DE TEST CMS FLEXIBLE / RACCORD MÂLE Ø0,8MM
 FLEXIBEL SMD KLEMMPRÜFSPITZE / Ø0,8MM STECKERANSCHLUSS

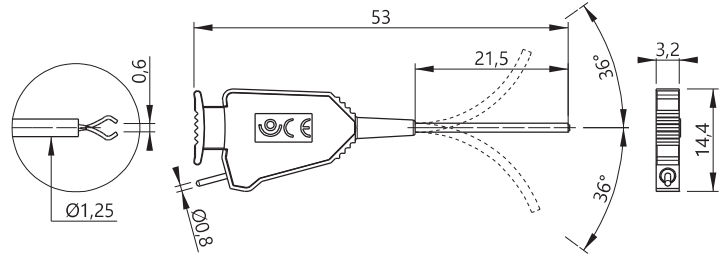

Reference
Référence
Bestell-Nr **6606-080-#**

Rated voltage Tension assignée Bemessungsspannung	Rated current Intensité assignée Bemessungsstrom	Contact parts Contacts Kontaktteile	Insulation Isolant Isolierteile	Colours [#] Couleurs [#] Farben [#]																												
≤30VAC ≤60VDC	1A	Steel and Brass / AuNi coated Acier et Laiton / Revêtement AuNi Edelstahl und Messing vergoldet	PA6.6	<table border="0"> <tr> <td>R</td><td>N</td><td>BL</td><td>V</td><td>J</td><td>BC</td><td>VT</td> </tr> <tr> <td>2</td><td>0</td><td>6</td><td>5</td><td>4</td><td>9</td><td>7</td> </tr> <tr> <td>0</td><td>BN</td><td>G</td><td></td><td></td><td></td><td></td> </tr> <tr> <td>3</td><td>1</td><td>8</td><td></td><td></td><td></td><td></td> </tr> </table>	R	N	BL	V	J	BC	VT	2	0	6	5	4	9	7	0	BN	G					3	1	8				
R	N	BL	V	J	BC	VT																										
2	0	6	5	4	9	7																										
0	BN	G																														
3	1	8																														



Our mini clips with revolving bodies are completely suitable for SMD technology. The shaft with its plastic covering can be bent up to 36 °
 Nos mini pincettes, avec corps tournants sont parfaitement adaptées à la technologie CMS. La tige, avec son revêtement plastique, peut se plier jusqu'à 36 °
 Unsere Miniatur-Klemmprüfspitzen mit drehbaren Pinzetten sind ein ideales Werkzeug für die SMD Technologie. Der Stiel mit Plastikschild ist bis zu 36 ° biegsam

TYPE 6606-D2

TEST LEAD: FLEXIBLE SMD TEST CLIP / Ø2MM BANANA JACK
CORDON: PINCE DE TEST CMS FLEXIBLE / FICHE BANANE FEMELLE Ø2MM
 MESSLEITUNG: FLEXIBEL SMD KLEMMPRÜFSPITZE / Ø2MM BANANENBUCHSE

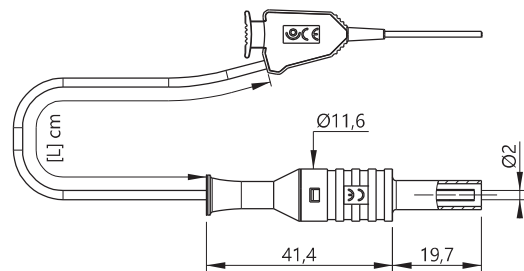

Reference
Référence
Bestell-Nr **6606-D2-[L]-#**

Wire
Câble
Litze SIL 0,40 mm²

Lengths Longueurs Längen [cm]	Rated voltage Tension assignée Bemessungsspannung	Rated current Intensité assignée Bemessungsstrom	Contact parts Contacts Kontaktteile	Insulation Isolant Isolierteile	Colours [#] Couleurs [#] Farben [#]																												
10 50	≤30VAC ≤60VDC	1A	Steel and Brass / Ni coated Acier et Laiton / Revêtement Ni Edelstahl & Messing vernickelt	PA6	<table border="0"> <tr> <td>R</td><td>N</td><td>BL</td><td>V</td><td>J</td><td>BC</td><td>VT</td> </tr> <tr> <td>2</td><td>0</td><td>6</td><td>5</td><td>4</td><td>9</td><td>7</td> </tr> <tr> <td>0</td><td>BN</td><td>G</td><td></td><td></td><td></td><td></td> </tr> <tr> <td>3</td><td>1</td><td>8</td><td></td><td></td><td></td><td></td> </tr> </table>	R	N	BL	V	J	BC	VT	2	0	6	5	4	9	7	0	BN	G					3	1	8				
R	N	BL	V	J	BC	VT																											
2	0	6	5	4	9	7																											
0	BN	G																															
3	1	8																															



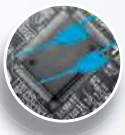

MICRO TEST • MICRO MESURE • MICRO TEST

Mini clips for SMD tests • Mini pinces de test CMS • SMD Miniatur-Klemmprüfspitzen

TYPE 6606-D4

TEST LEAD: FLEXIBLE SMD TEST CLIP / Ø4MM BANANA JACK
CORDON: PINCE DE TEST CMS FLEXIBLE / FICHE BANANE FEMELLE Ø4MM
MESSLEITUNG: FLEXIBEL SMD KLEMMPRÜFSPITZE / Ø4MM BANANENBUCHSE

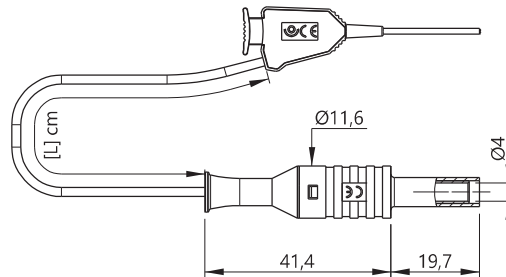
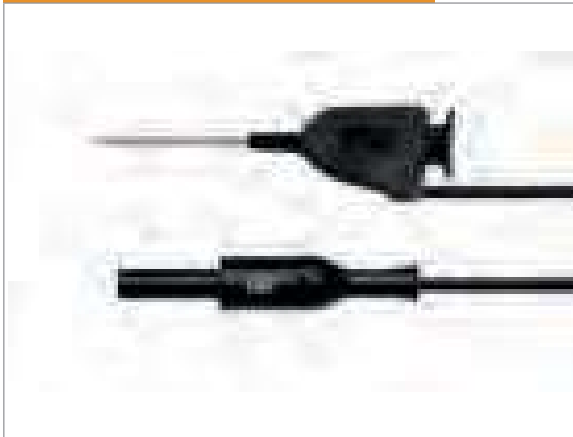

Reference
Référence
Bestell-Nr **6606-D4-[L]-#**

Wire
Câble
Litze SIL 0,40 mm²

Lengths Longueurs Längen [cm]	Rated voltage Tension assignée Bemessungsspannung	Rated current Intensité assignée Bemessungsstrom	Contact parts Contacts Kontaktteile	Insulation Isolant Isolierteile	Colours [#] Couleurs [#] Farben [#]																												
10 50	≤30VAC ≤60VDC	1A	Steel and Brass / Ni coated Acier et Laiton / Revêtement Ni Edelstahl & Messing vernickelt	PA6	<table border="0"> <tr> <td>R</td><td>N</td><td>BL</td><td>V</td><td>J</td><td>BC</td><td>VT</td> </tr> <tr> <td>2</td><td>0</td><td>6</td><td>5</td><td>4</td><td>9</td><td>7</td> </tr> <tr> <td>0</td><td>BN</td><td>G</td><td></td><td></td><td></td><td></td> </tr> <tr> <td>3</td><td>1</td><td>8</td><td></td><td></td><td></td><td></td> </tr> </table>	R	N	BL	V	J	BC	VT	2	0	6	5	4	9	7	0	BN	G					3	1	8				
R	N	BL	V	J	BC	VT																											
2	0	6	5	4	9	7																											
0	BN	G																															
3	1	8																															

x5

TYPE 6606

TEST LEAD: FLEXIBLE SMD TEST CLIP / OPEN SIDE
CORDON: PINCE DE TEST CMS FLEXIBLE / CÔTÉ OUVERT
MESSLEITUNG: FLEXIBEL SMD KLEMMPRÜFSPITZE / OFFENE SEITE

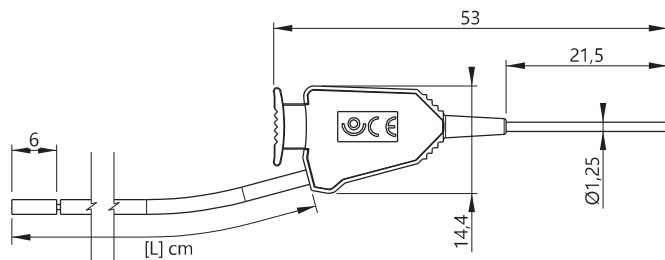

Reference
Référence
Bestell-Nr **6606-[L]-#**

Wire
Câble
Litze SIL 0,40 mm²

Lengths Longueurs Längen [cm]	Rated voltage Tension assignée Bemessungsspannung	Rated current Intensité assignée Bemessungsstrom	Contact parts Contacts Kontaktteile	Insulation Isolant Isolierteile	Colours [#] Couleurs [#] Farben [#]																												
50 100	≤30VAC ≤60VDC	1A	Steel and Brass / Ni coated Acier et Laiton / Revêtement Ni Edelstahl & Messing vernickelt	PA6	<table border="0"> <tr> <td>R</td><td>N</td><td>BL</td><td>V</td><td>J</td><td>BC</td><td>VT</td> </tr> <tr> <td>2</td><td>0</td><td>6</td><td>5</td><td>4</td><td>9</td><td>7</td> </tr> <tr> <td>0</td><td>BN</td><td>G</td><td></td><td></td><td></td><td></td> </tr> <tr> <td>3</td><td>1</td><td>8</td><td></td><td></td><td></td><td></td> </tr> </table>	R	N	BL	V	J	BC	VT	2	0	6	5	4	9	7	0	BN	G					3	1	8				
R	N	BL	V	J	BC	VT																											
2	0	6	5	4	9	7																											
0	BN	G																															
3	1	8																															

x5



MICRO TEST • MICRO MESURE • MICRO TEST

Mini clips for SMD tests • Mini pinces de test CMS • SMD Miniatur-Klemmprüfspitzen

TYPE 6606-02

TEST LEAD: TWO FLEXIBLE SMD TEST CLIPS
CORDON: DEUX PINCES DE TEST CMS FLEXIBLE
MESSELEITUNG: BEIDSEITIG FLEXIBEL SMD KLEMMPRÜFSPITZE

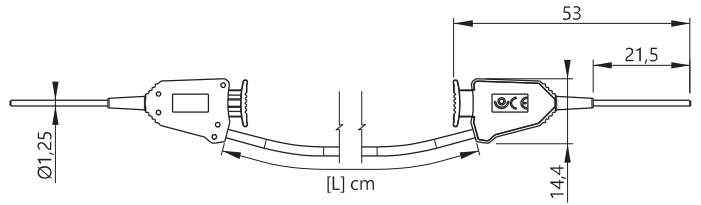
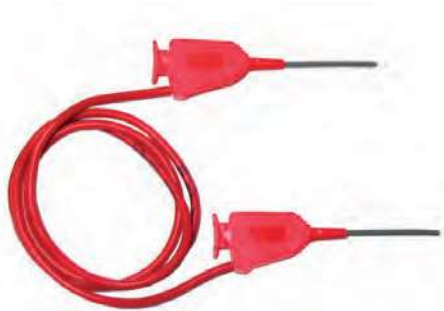

Reference Référence Bestell-Nr	6606-02-[L]-#			Wire Câble Litze	SIL 0,40 mm ²																												
Lengths Longueurs Längen [cm]	Rated voltage Tension assignée Bemessungsspannung	Rated current Intensité assignée Bemessungsstrom	Contact parts Contacts Kontaktteile	Insulation Isolant Isolierteile	Colours [#] Couleurs [#] Farben [#]																												
50 100	≤30VAC ≤60VDC	1A	Steel and Brass / Ni coated Acier et Laiton / Revêtement Ni Edelstahl & Messing vernickelt	PA6	<table border="1"> <tr> <td>R</td><td>N</td><td>BL</td><td>V</td><td>J</td><td>BC</td><td>VT</td> </tr> <tr> <td>2</td><td>0</td><td>6</td><td>5</td><td>4</td><td>9</td><td>7</td> </tr> <tr> <td>0</td><td>BN</td><td>G</td><td></td><td></td><td></td><td></td> </tr> <tr> <td>3</td><td>1</td><td>8</td><td></td><td></td><td></td><td></td> </tr> </table>	R	N	BL	V	J	BC	VT	2	0	6	5	4	9	7	0	BN	G					3	1	8				
R	N	BL	V	J	BC	VT																											
2	0	6	5	4	9	7																											
0	BN	G																															
3	1	8																															

x5

TYPE 6012-PRO

SMD TEST CLIP / SOLDER CONNEXION, DO-IT-YOURSELF ASSEMBLING
PINCE DE TEST CMS / RACCORD SOUDURE, MONTAGE PAR
L'UTILISATEUR
SMD KLEMMPRÜFSPITZE / LÖTANSCHLUSS, SELBSTMONTAGE

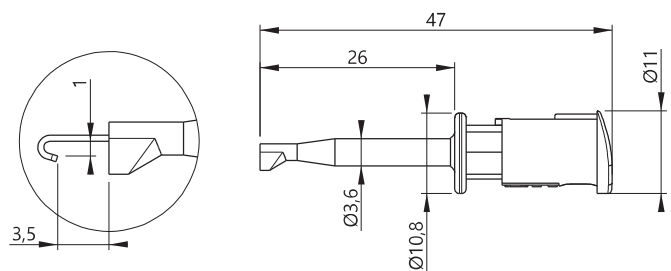

Reference Référence Bestell-Nr	6012-PRO-#																																
Rated voltage Tension assignée Bemessungsspannung	Rated current Intensité assignée Bemessungsstrom	Contact parts Contacts Kontaktteile	Insulation Isolant Isolierteile	Colours [#] Couleurs [#] Farben [#]																													
≤30VAC ≤60VDC	6A	AuNi coated brass Laiton doré Messing vergoldet	PP - PA6	<table border="1"> <tr> <td>R</td><td>N</td><td>BL</td><td>V</td><td>J</td><td>BC</td><td>VT</td> </tr> <tr> <td>2</td><td>0</td><td>6</td><td>5</td><td>4</td><td>9</td><td>7</td> </tr> <tr> <td>0</td><td>BN</td><td>G</td><td></td><td></td><td></td><td></td> </tr> <tr> <td>3</td><td>1</td><td>8</td><td></td><td></td><td></td><td></td> </tr> </table>	R	N	BL	V	J	BC	VT	2	0	6	5	4	9	7	0	BN	G					3	1	8					
R	N	BL	V	J	BC	VT																											
2	0	6	5	4	9	7																											
0	BN	G																															
3	1	8																															

x10

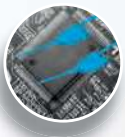

MICRO TEST • MICRO MESURE • MICRO TEST

Mini clips for SMD tests • Mini pinces de test CMS • SMD Miniatur-Klemmprüfspitzen

TYPE 6020-PRO

TEST LEAD: SMD TEST CLIP / OPEN SIDE
 CORDON DE MESURE: PINCE DE TEST CMS / CÔTÉ OUVERT
 MESSLEITUNG: SMD KLEMMPRÜFSPITZE / OFFENE SEITE

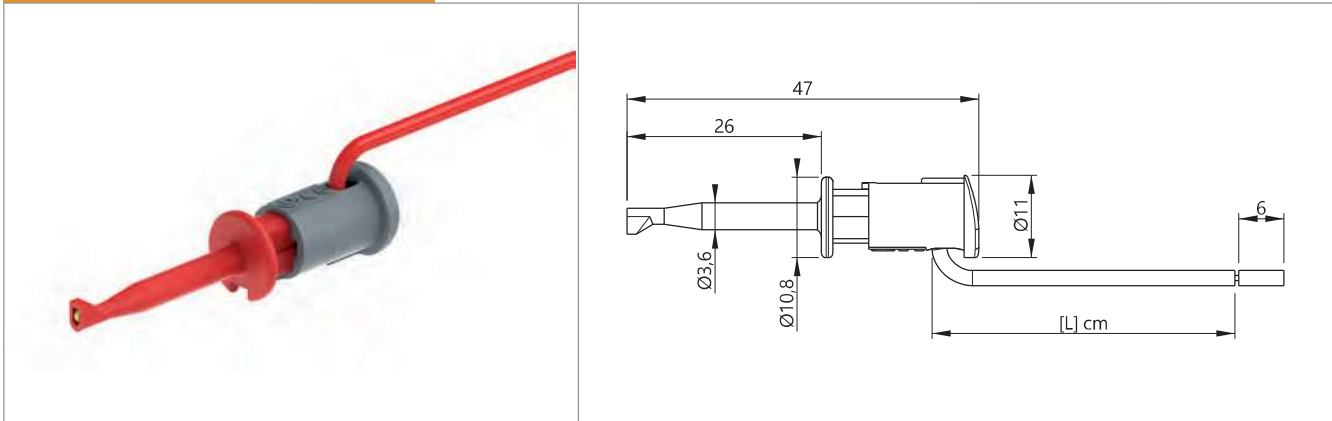

Reference
Référence
Bestell-Nr **6020-PRO-#**

Wire
Câble
Litze PVC 0,40 mm² (Grey / Gris / Grau)

Lengths Longueurs Längen [cm]	Rated voltage Tension assignée Bemessungsspannung	Rated current Intensité assignée Bemessungsstrom	Contact parts Contacts Kontaktteile	Insulation Isolant Isolierteile	Colours [#] Couleurs [#] Farben [#]																												
100	≤30VAC ≤60VDC	6A	AuNi coated brass Laiton doré Messing vergoldet	PP - PA6	<table border="0"> <tr> <td>R</td><td>N</td><td>BL</td><td>V</td><td>J</td><td>BC</td><td>VT</td> </tr> <tr> <td>2</td><td>0</td><td>6</td><td>5</td><td>4</td><td>9</td><td>7</td> </tr> <tr> <td>0</td><td>BN</td><td>G</td><td></td><td></td><td></td><td></td> </tr> <tr> <td>3</td><td>1</td><td>8</td><td></td><td></td><td></td><td></td> </tr> </table>	R	N	BL	V	J	BC	VT	2	0	6	5	4	9	7	0	BN	G					3	1	8				
R	N	BL	V	J	BC	VT																											
2	0	6	5	4	9	7																											
0	BN	G																															
3	1	8																															

x10

TYPE 6020-PRO-Spi

TEST LEAD: SMD TEST CLIP / OPEN SIDE
 CORDON DE MESURE: PINCE DE TEST CMS / CÔTÉ OUVERT
 MESSLEITUNG: SMD KLEMMPRÜFSPITZE / OFFENE SEITE

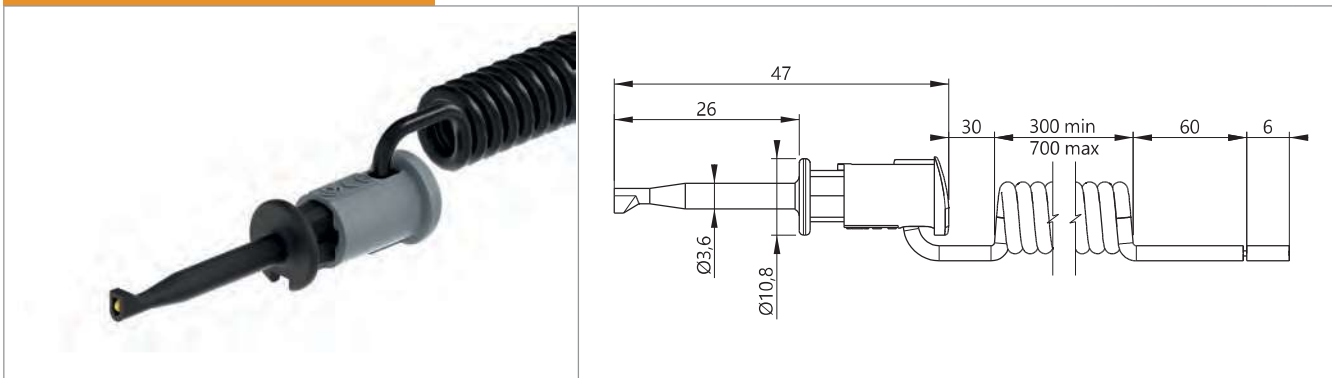

Reference
Référence
Bestell-Nr **6020-PRO-Spi-#**

Wire
Câble
Litze Coiled cable PVC 0,40 mm² Grey
Câble spiralé PVC 0,40 mm² Gris
Spiralkabel PVC 0,40 mm² Grau

Lengths Longueurs Längen [cm]	Rated voltage Tension assignée Bemessungsspannung	Rated current Intensité assignée Bemessungsstrom	Contact parts Contacts Kontaktteile	Insulation Isolant Isolierteile	Colours [#] Couleurs [#] Farben [#]																												
30 - 70 cm	≤30VAC ≤60VDC	6A	AuNi coated brass Laiton doré Messing vergoldet	PP - PA6	<table border="0"> <tr> <td>R</td><td>N</td><td>BL</td><td>V</td><td>J</td><td>BC</td><td>VT</td> </tr> <tr> <td>2</td><td>0</td><td>6</td><td>5</td><td>4</td><td>9</td><td>7</td> </tr> <tr> <td>0</td><td>BN</td><td>G</td><td></td><td></td><td></td><td></td> </tr> <tr> <td>3</td><td>1</td><td>8</td><td></td><td></td><td></td><td></td> </tr> </table>	R	N	BL	V	J	BC	VT	2	0	6	5	4	9	7	0	BN	G					3	1	8				
R	N	BL	V	J	BC	VT																											
2	0	6	5	4	9	7																											
0	BN	G																															
3	1	8																															

x10



MICRO TEST • MICRO MESURE • MICRO TEST

Mini clips for SMD tests • Mini pinces de test CMS • SMD Miniatur-Klemmprüfspitzen

TYPE 6022-PRO

TEST LEAD: TWO SMD TEST CLIPS
 CORDON DE MESURE: DEUX PINCES DE TEST CMS
 MESSLEITUNG: SMD KLEMMPRÜFSPITZE BEIDSEITIG

KIT 6032-PRO p.191

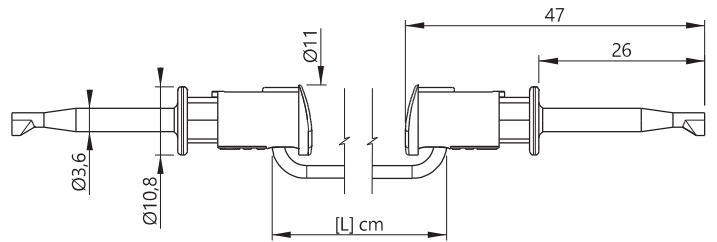

Reference Référence Bestell-Nr	6022-PRO-#		Wire Câble Litze	PVC 0,40 mm ² (Grey / Gris / Grau)							
Lengths Longueurs Längen [cm]	Rated voltage Tension assignée Bemessungsspannung	Rated current Intensité assignée Bemessungsstrom	Contact parts Contacts Kontaktteile	Insulation Isolant Isolierteile	Colours [#] Couleurs [#] Farben [#]						
100	≤30VAC ≤60VDC	6A	AuNi coated brass Laiton doré <i>Messing vergoldet</i>	PP - PA6	R 2	N 0	BL 6	V 5	J 4	BC 9	VT 7
					0	BN	G				
					3	1	8				

x10

TYPE 6022-PRO-Spi

TEST LEAD: TWO SMD TEST CLIPS
 CORDON DE MESURE: DEUX PINCES DE TEST CMS
 MESSLEITUNG: SMD KLEMMPRÜFSPITZE BEIDSEITIG

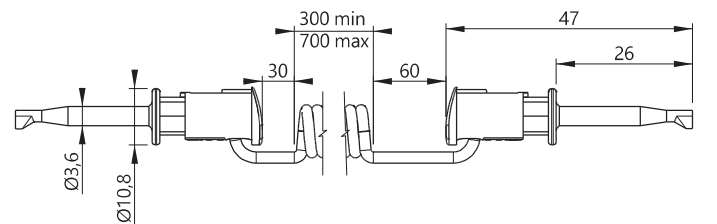

Reference Référence Bestell-Nr	6022-PRO-Spi-#		Wire Câble Litze	Coiled cable PVC 0,40 mm ² Grey Câble spiralé PVC 0,40 mm ² Gris Spiralkabel PVC 0,40 mm ² Grau							
Lengths Longueurs Längen [cm]	Rated voltage Tension assignée Bemessungsspannung	Rated current Intensité assignée Bemessungsstrom	Contact parts Contacts Kontaktteile	Insulation Isolant Isolierteile	Colours [#] Couleurs [#] Farben [#]						
30 - 70 cm	≤30VAC ≤60VDC	6A	AuNi coated brass Laiton doré <i>Messing vergoldet</i>	PP - PA6	R 2	N 0	BL 6	V 5	J 4	BC 9	VT 7
					0	BN	G				
					3	1	8				

x10

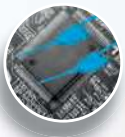

MICRO TEST • MICRO MESURE • MICRO TEST

Mini clips for SMD tests • Mini pinces de test CMS • SMD Miniatur-Klemmprüfspitzen

TYPE 6033-PRO

TEST LEAD: SMD TEST CLIPS / Ø4MM BANANA PLUG
 CORDON DE MESURE: PINCE DE TEST CMS / FICHE BANANE MÂLE Ø4MM
 MESSLEITUNG: SMD KLEMMPRÜFSPITZE / Ø4MM BANANENSTECKER

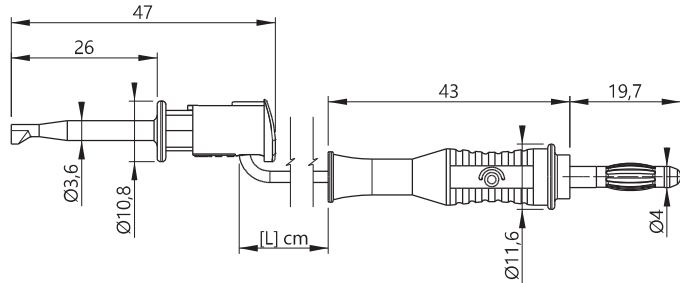

Reference
Référence
Bestell-Nr **6033-PRO-#**

Wire
Câble
Litze PVC 0,40 mm² (Grey / Gris / Grau)

Lengths Longueurs Längen [cm]	Rated voltage Tension assignée Bemessungsspannung	Rated current Intensité assignée Bemessungsstrom	Contact parts Contacts Kontaktteile	Insulation Isolant Isolierteile	Colours [#] Couleurs [#] Farben [#]												
100	≤30VAC ≤60VDC	6A	AuNi coated brass Laiton doré Messing vergoldet	PP - PA6	<table border="1"> <tr> <td>R</td><td>N</td><td>BL</td><td>V</td><td>J</td><td>BC</td> </tr> <tr> <td>2</td><td>0</td><td>6</td><td>5</td><td>4</td><td>9</td> </tr> </table>	R	N	BL	V	J	BC	2	0	6	5	4	9
R	N	BL	V	J	BC												
2	0	6	5	4	9												

x10

TYPE 6034-PRO

TEST LEAD: SMD TEST CLIPS / Ø4MM BANANA JACK
 CORDON DE MESURE: PINCE DE TEST CMS / FICHE BANANE FEMELLE Ø4MM
 MESSLEITUNG: SMD KLEMMPRÜFSPITZE / Ø4MM BANANENBUCHSE

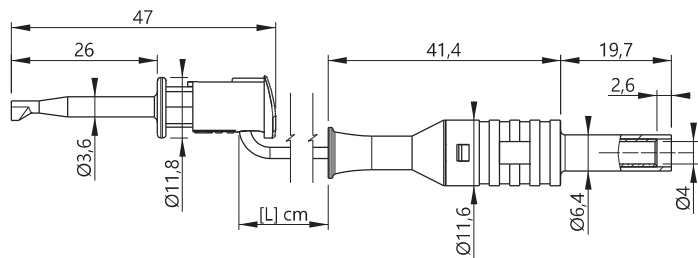

Reference
Référence
Bestell-Nr **6034-PRO-F-10-#**

Wire
Câble
Litze PVC 0,40 mm² (Grey / Gris / Grau)

Lengths Longueurs Längen [cm]	Rated voltage Tension assignée Bemessungsspannung	Rated current Intensité assignée Bemessungsstrom	Contact parts Contacts Kontaktteile	Insulation Isolant Isolierteile	Colours [#] Couleurs [#] Farben [#]												
10	≤30VAC ≤60VDC	6A	AuNi coated brass Laiton doré Messing vergoldet	PP - PA6	<table border="1"> <tr> <td>R</td><td>N</td><td>BL</td><td>V</td><td>J</td><td>BC</td> </tr> <tr> <td>2</td><td>0</td><td>6</td><td>5</td><td>4</td><td>9</td> </tr> </table>	R	N	BL	V	J	BC	2	0	6	5	4	9
R	N	BL	V	J	BC												
2	0	6	5	4	9												

x10



MICRO TEST • MICRO MESURE • MICRO TEST

Mini clips for SMD tests • Mini pincettes de test CMS • SMD Miniatur-Klemmprüfspitzen

TYPE 6035-PRO

TEST LEAD: SMD TEST CLIPS / Ø4MM SAFETY BANANA PLUG
 CORDON DE MESURE: PINCE DE TEST CMS / FICHE BANANE MÂLE Ø4MM DE SÉCURITÉ
 MESSLEITUNG: SMD KLEMMPRÜFSPITZE / Ø4MM SICHERHEITS-BANANENSTECKER

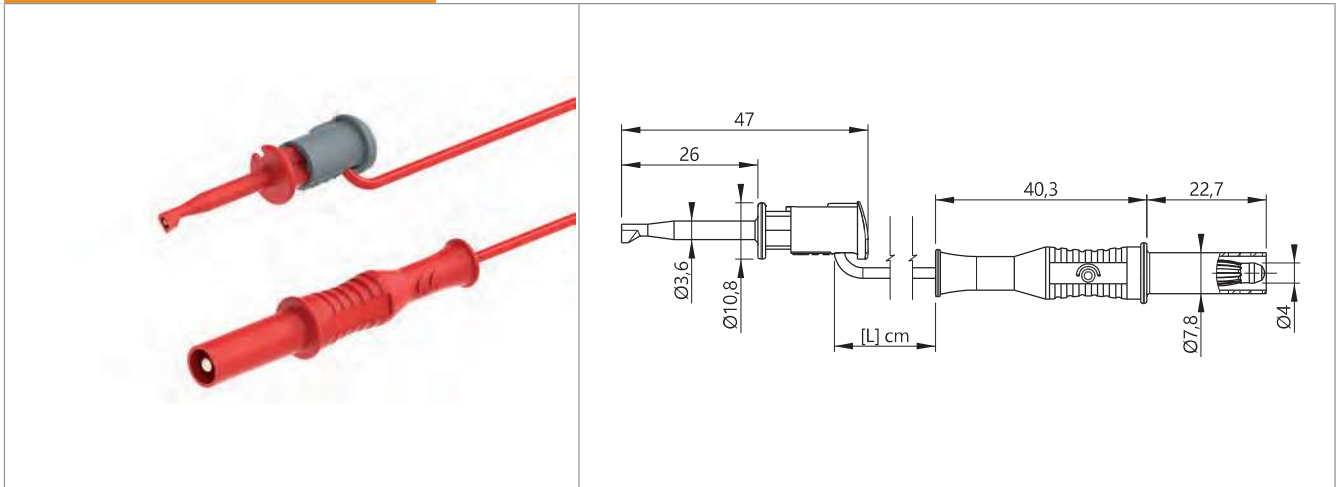

Reference Référence Bestell-Nr	6035-PRO-M-10-#		Wire Câble Litze	PVC 0,40 mm ² (Grey / Gris / Grau)						
Lengths Longueurs Längen [cm]	Rated voltage Tension assignée Bemessungsspannung	Rated current Intensité assignée Bemessungsstrom	Contact parts Contacts Kontaktteile	Insulation Isolant Isolierteile	Colours [#] Couleurs [#] Farben [#]					
10	≤30VAC ≤60VDC	6A	AuNi coated brass Laiton doré Messing vergoldet	PP - PA6	R 2	N 0	BL 6	V 5	J 4	BC 9

x10

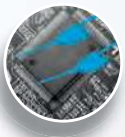

MICRO TEST • MICRO MESURE • MICRO TEST

Mini test tips for SMD tests • Mini pointes de test CMS • SMD Miniatur-Prüfspitzen

TYPE 464IECNeedle

Ø0,6MM TEST TIP WITH Ø4MM CONNEXION
POINTE DE TEST AIGUILLE Ø0,6MM AVEC RACCORD Ø4MM
 Ø0,6MM MINIATUR-NADELPRÜFSPITZE MIT Ø4MM ANSCHLUSS

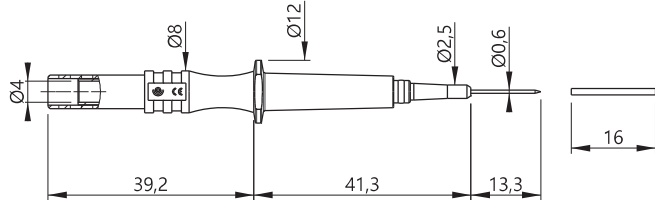
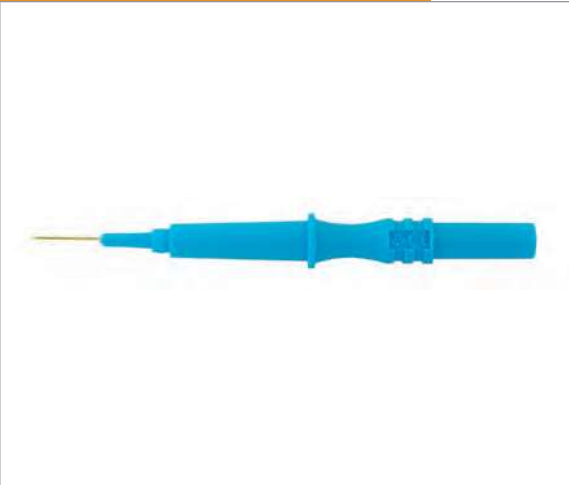

Reference
Référence
 Bestell-Nr **464IECNeedle13/0.6-#**

Rated voltage Tension assignée Bemessungsspannung	Rated current Intensité assignée Bemessungsstrom	Contact parts Contacts Kontaktteile	Insulation Isolant Isolierteile	Colours [#] Couleurs [#] Farben [#]												
600 V CAT II	1A	Ni Brass coated (tip uncoated) Laiton nickelé (pointe non revêtue) Messing vernickelt (Spitze nicht beschichtet)	PP	<table border="1"> <tr> <td>R</td> <td>N</td> <td>BL</td> <td>V</td> <td>J</td> <td>BC</td> </tr> <tr> <td>2</td> <td>0</td> <td>6</td> <td>5</td> <td>4</td> <td>9</td> </tr> </table>	R	N	BL	V	J	BC	2	0	6	5	4	9
R	N	BL	V	J	BC											
2	0	6	5	4	9											

x10

TYPE 464-IEC

Ø0,7MM SPRING LOADED TEST TIP WITH Ø4MM CONNEXION
POINTE DE TEST Ø0,7MM À RESSORT AVEC RACCORD Ø4MM
 Ø0,7MM GEFEDERTE MINIATUR-PRÜFSPITZE MIT Ø4MM ANSCHLUSS

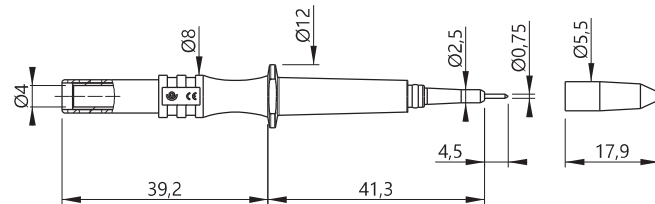

Reference
Référence
 Bestell-Nr **464-IEC-#**

Rated voltage Tension assignée Bemessungsspannung	Rated current Intensité assignée Bemessungsstrom	Contact parts Contacts Kontaktteile	Insulation Isolant Isolierteile	Colours [#] Couleurs [#] Farben [#]												
600 V CAT II	1A	Steel and Brass / Ni coated Acier et Laiton / Revêtement Ni EdelStahl & Messing vernickelt	PP	<table border="1"> <tr> <td>R</td> <td>N</td> <td>BL</td> <td>V</td> <td>J</td> <td>BC</td> </tr> <tr> <td>2</td> <td>0</td> <td>6</td> <td>5</td> <td>4</td> <td>9</td> </tr> </table>	R	N	BL	V	J	BC	2	0	6	5	4	9
R	N	BL	V	J	BC											
2	0	6	5	4	9											

x10

Test tip fitted with protective cap in order to avoid short-circuits. Suitable for active circuits
Pointe équipée d'un embout protecteur pour éviter les courts circuits. Idéal pour circuits actifs
 Spitze mit Schutzkappe versehen, um Kurzschlüsse zu verhindern. Geeignet für aktive Bauelemente



MICRO TEST • MICRO MESURE • MICRO TEST

Mini test tips for SMD tests • Mini pointes de test CMS • SMD Miniatur-Prüfspitzen

TYPE 462-IEC

Ø0,7MM SPRING LOADED TEST TIP WITH Ø2MM CONNEXION
POINTE DE TEST Ø0,7MM À RESSORT AVEC RACCORD Ø2MM
Ø0,7MM GEFEDERTE MINIATUR-PRÜFSPITZE MIT Ø2MM ANSCHLUSS

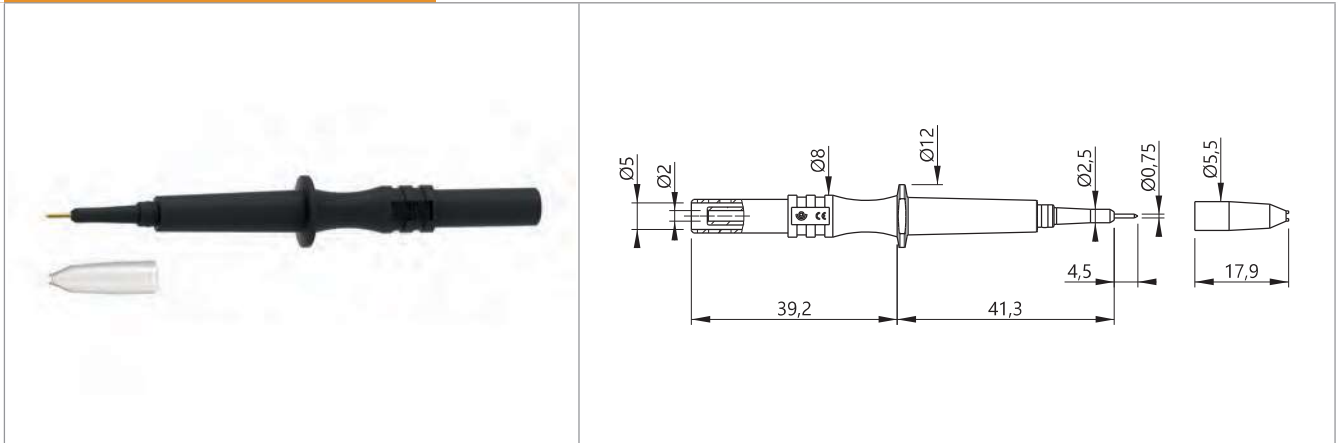

Reference
Référence 462-IEC-#
 Bestell-Nr

Rated voltage Tension assignée Bemessungsspannung	Rated current Intensité assignée Bemessungsstrom	Contact parts Contacts Kontaktteile	Insulation Isolant Isolierteile	Colours [#] Couleurs [#] Farben [#]												
600 V CAT II	1A	Steel and Brass / Ni coated Acier et Laiton / Revêtement Ni EdelStahl & Messing vernickelt	PP	<table border="1"> <tr> <td>R</td> <td>N</td> <td>BL</td> <td>V</td> <td>J</td> <td>BC</td> </tr> <tr> <td>2</td> <td>0</td> <td>6</td> <td>5</td> <td>4</td> <td>9</td> </tr> </table>	R	N	BL	V	J	BC	2	0	6	5	4	9
R	N	BL	V	J	BC											
2	0	6	5	4	9											



Test tip fitted with protective cap in order to avoid short-circuits, Suitable for active circuits
Pointe équipée d'un embout protecteur pour éviter les courts circuits. Idéal pour circuits actifs
Spitze mit Schutzkappe versehen, um Kurzschlüsse zu verhindern. Geeignet für aktive Bauelemente